

# LoFric<sup>®</sup> Dila-Cath<sup>™</sup>



Connector has different colours depending on the diameter of the catheter.



Catheter tube with Urotonic<sup>™</sup> Surface Technology. Gives the lowest friction during insertion and withdrawal.

## Intended Use

- Hydrophilic single use dilatation catheter
- Dilatation

## Sterilisation & Shelf Life

All catheters are sterilised by ethylene oxide gas. Information about the recommended best-before date is printed on the package.

## Package

25 catheters per carton  
4 cartons per shipping box

## Material Composition

**Hydrophilic surface coating:** Polyvinyl pyrrolidone (PVP) and table salt (NaCl)

**Catheter:** medical grade polyvinyl chloride (PVC)

**Item sterile package:** Lacquered paper, laminated film of polypropylene (PP) and polyethylene (PE)

## Product Range

Ref.no	Type	Length	Size
89 16 00	LoFric <sup>®</sup> Dila-Cath Nelaton	40 cm	CH 16
89 18 00	LoFric <sup>®</sup> Dila-Cath Nelaton	40 cm	CH 18

# Instructions

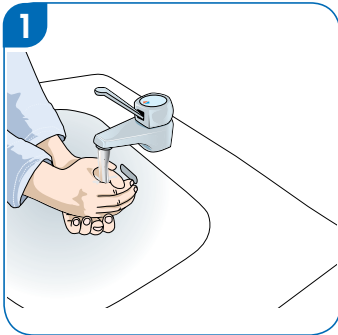

**1.** Wash your hands with soap and water.

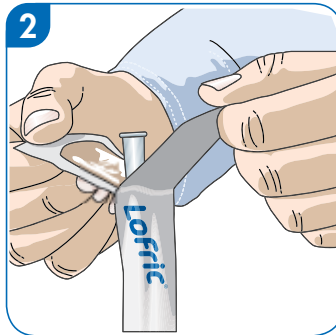

**2.** Open the package by pulling the flaps apart 5–6 cm.

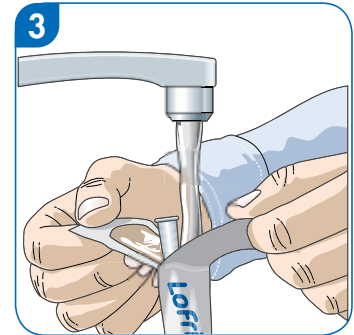

**3.** Fill with water directly into the package. Fill nearly to the top. Drinking water, sterile water or sodium chloride solution is OK.

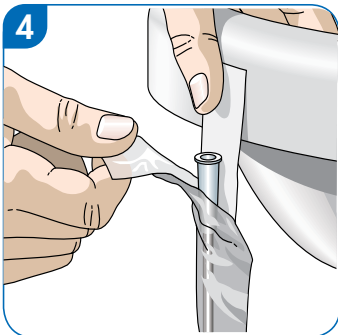

**4.** The package has an adhesive sticker. Remove the blue protective strip and attach the package to a dry surface.

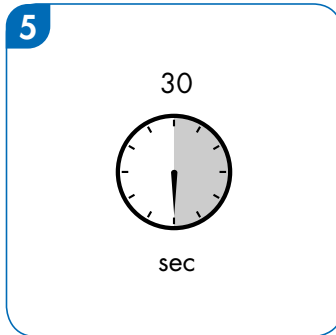

**5.** Immerse the catheter for 30 seconds while you prepare yourself. Carry out the dilatation as soon as possible.