

*Luer-Lock. A connector type that is equally safe as it is well-known by health care staff. The closed system minimises the risk of spillage and unintentional exposure. Toxic medication is held completely enclosed.*



*Catheter tube with Urotonic<sup>™</sup> Surface Technology. Gives the lowest friction during insertion and withdrawal.*

## Intended Use

- Hydrophilic single use catheter for instillation.
- For home or health care use

## Sterilisation & Shelf Life

All catheters are sterilised by ethylene oxide gas. Information about the recommended best-before date is printed on the package.

## Package

25 catheters per carton  
4 cartons per shipping box

## Material Composition

**Hydrophilic surface coating:**  
Polyvinyl pyrrolidone (PVP) and table salt (NaCl)

**Catheter:** medical grade polyvinyl chloride (PVC)

**Item sterile package:**  
Lacquered paper, laminated film of polypropylene (PP) and polyethylene (PE)

## Product Range

Ref.no	Type	Length	Size
80 08 00	LoFric <sup>®</sup> Insti-Cath Nelaton	40 cm	CH 08
80 10 00	LoFric <sup>®</sup> Insti-Cath Nelaton	40 cm	CH 10
80 12 00	LoFric <sup>®</sup> Insti-Cath Nelaton	40 cm	CH 12
80 14 00	LoFric <sup>®</sup> Insti-Cath Nelaton	40 cm	CH 14
81 08 00	LoFric <sup>®</sup> Insti-Cath Nelaton	20 cm	CH 08
81 10 00	LoFric <sup>®</sup> Insti-Cath Nelaton	20 cm	CH 10
81 12 00	LoFric <sup>®</sup> Insti-Cath Nelaton	20 cm	CH 12
81 14 00	LoFric <sup>®</sup> Insti-Cath Nelaton	20 cm	CH 14
81 28 00	LoFric <sup>®</sup> Insti-Cath Paediatric	20 cm	CH 08
81 30 00	LoFric <sup>®</sup> Insti-Cath Paediatric	20 cm	CH 10
82 10 00	LoFric <sup>®</sup> Insti-Cath Tiemann	40 cm	CH 10
82 12 00	LoFric <sup>®</sup> Insti-Cath Tiemann	40 cm	CH 12
82 14 00	LoFric <sup>®</sup> Insti-Cath Tiemann	40 cm	CH 14

# Instructions

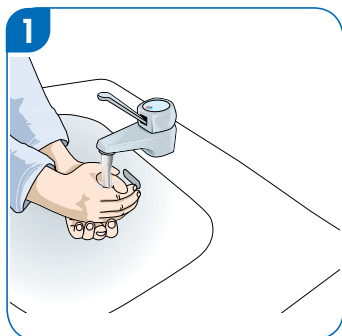

**1.** Wash your hands with soap and water.

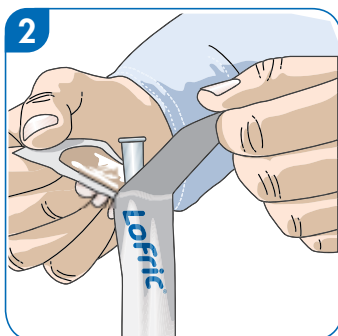

**2.** Open the package by pulling the flaps apart 5–6 cm.

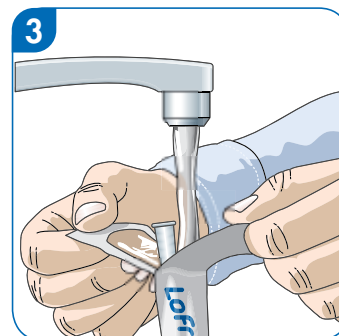

**3.** Fill with water directly into the package. Fill nearly to the top. Drinking water, sterile water or sodium chloride solution is OK.

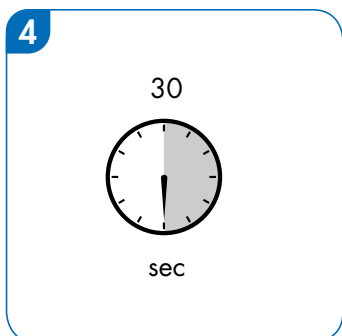

**4.** Immerse the catheter for 30 seconds while you prepare yourself. Carry out the dilatation as soon as possible.

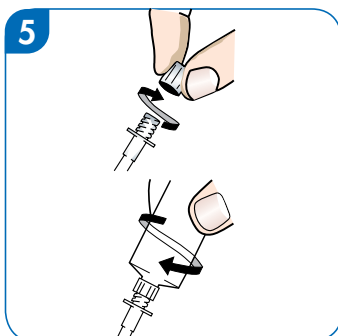

**5.** Unscrew the top from the catheter connector. Apply the drug container and perform the instillation.